

Technical Specification

Dimensions (Frame):	86mm X 86mm X 8mm
Dimensions (Electronic Part):	41mm X 41mm X 20mm
Casing Material:	Aluminium, Brass, Nickel, Copper and Aged Brass depending on the finish selection
Power:	30 VDC - from KNX Bus Line
Consumption:	< 12 mA from KNX Bus-line
Connectivity:	KNX-TP
Programming Tool:	ETS
Installation:	Italian Standard In Wall Box, 2M size and more
Operating Temperature:	0°C / +45°C
Storage Temperature:	-10°C / +55°C
Relative Humidity:	95% not condensing
Certification:	Device complies with Electromagnetic Compatibility Directive(2014/30/EU). Tests carried out according to EN55032:2015 and EN55035:2017.

Dimensional drawing (all dimensions are in mm)

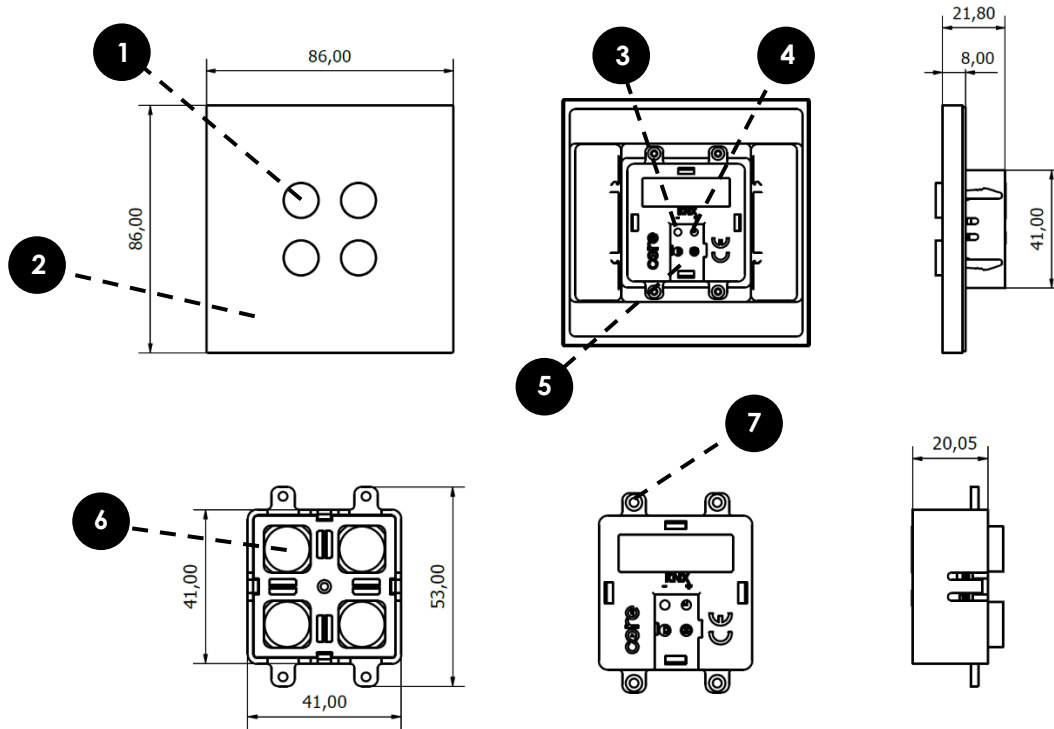

1. Button Metal Part (Sold Separately)
2. Frame (Sold Separately)
3. KNX Programming Button
4. KNX Programming Led
5. KNX Connector
6. Buttons with RGB Led
7. Screw Holes