

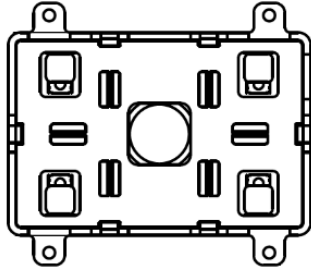

## Quick Start Guide

### Surface 3 Module 1 Button PB Switch



CR-SFS-3M-KNX-01

#### Package Contents

- Core Surface Modular 3M Switch
- Electronic Part Cover
- Screws
- Connectors

Core Bina Otomasyon Sistemleri Ltd. Şti.

Fatih Mahallesi Ege Caddesi No:42/5

Gazimür - İzmir - Türkiye

www.core.com.tr



## CONCEPT DESCRIPTION

<b>Led colours:</b>	White, red, green, blue, yellow, magenta, cyan
<b>Dimensions:</b>	41mm X 61mm X 20mm
<b>Casing Material:</b>	Aluminium, Brass, Nickel, Copper and Aged Brass depending on the finish selection
<b>Power:</b>	29 VDC - 0,35 Watts from KNX Bus-line
<b>Consumption:</b>	< 12 mA from KNX Bus-line
<b>Connectivity:</b>	KNX-TP
<b>Installation:</b>	Italian Standard In Wall Box, 3M size and more

#### To be completed

Electronic Part

1 Button\*

Support\*

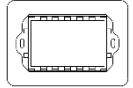

\*Sold separately

## Dimensional Drawing



## Safety Remarks



Dimensional drawing (all dimensions are in mm)

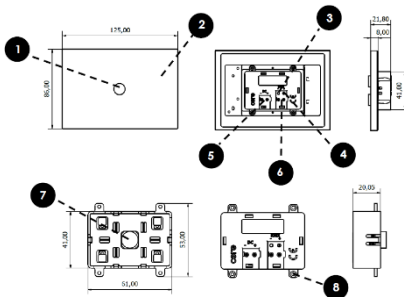

1. Button Metal Part (Sold Separately)
2. Frame (Sold Separately)
3. KNX Programming Button
4. KNX Programming Led
5. Auxiliary Power Connector (Not used)
6. KNX Connector
7. Button with RGB Led
8. Screw Holes

#### Warnings

- Installation, electrical connection, configuration and commissioning of the device can only be carried out by qualified personnel in compliance with the applicable technical standards and laws of the respective countries
- The electrical connection of the device can only be carried out by qualified personnel. The incorrect installation may result in electric shock or fire. Before making the electrical connections, make sure the power supply has been turned off.
- Do not connect the main voltage (230V AC) to KNX connector of the device.
- Opening the housing of the device causes the immediate end of warranty period.
- In case of tampering the compliance with the essential requirements of the applicable directives, for which device has been certified, is no longer guaranteed.
- To clean frame and buttons, use a dry cloth. It must be avoided the use of solvents or other aggressive substances.
- Contact with fluids to the plate and socket is to be avoided.

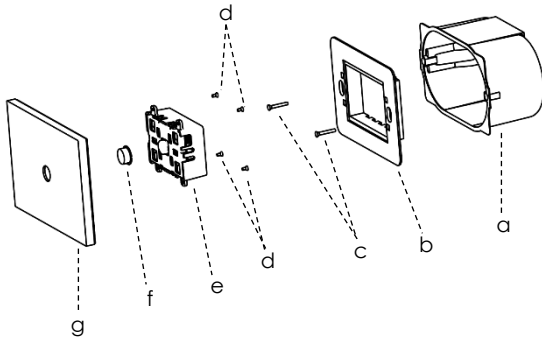

The installation of the device requires the following steps:

1. Place the mounting support (b) on the wall mounting box (a) and fix with screws (c)
2. Place metal buttons (f) on the electronic part (e)
3. Fit the frame (g) to the electronic part (e)
4. Mount the screws (d) to fix the electronic part (e) to the frame (g)
5. Connect KNX cable to the device. Check that polarity is correct
6. Press and place the device to the support with both hands simultaneously on the right and left sides

- a) Wall mounting box  
b) Mounting support (sold separately)  
c) Support fixing screws  
d) Electronic part fixing screws  
e) Electronic part  
f) Metal Buttons (sold separately)  
g) Frame (sold separately)

## Commissioning

- Commissioning and configuration of the device require the use of ETS4 or later releases. These activities must be carried out according to the design of the building automation system done by a qualified planner.

- For the configuration of the device parameters the corresponding application program or whole Core product database must be loaded in the ETS program. For detailed information on configuration options, refer to the application manual of the device available on the web site [www.core.com.tr](http://www.core.com.tr)

- For commissioning the device, the following activities are required
  - make the electrical connections as described above
  - turn on the bus power supply
  - switch the device operation to the programming mode
  - download into the device the physical address and the configuration with the ETS program

- At the end of the download the operation of the device returns to normal mode

- Now the bus device is programmed and ready to use