

Eclipse Push Button Switch is designed to control the ambient in a stylish way, thanks to premium materials and finishes. It is also equipped with multiple sensors to automate the ambient; thus becomes a switch, a sensor and a design material.

## Features

**CUSTOMIZABLE ICONS:** Icon or text can be engraved to each button in folds. Thanks to dedicated online planner, customer can select icons from extensive icon library or write text accordingly.

**RGB BACKLIGHTS:** RGB Backlights of the icons indicate the status of connected load. Color of the backlight can be configured via ETS programming tool.

**ADAPTIVE BACKLIGHTS:** Light sensor measures ambient light and icon backlights are dimmed according to the light level in the room.

**PROXIMITY SENSOR:** Proximity sensor senses the approach and backlights of icons are dimmed up to welcome customer in the dark ambient.

**BUILT-IN THERMOSTAT:** Eclipse PB Switch can control HVAC systems via built-in thermostat logic, temperature sensor and humidity sensor.

**AIR QUALITY MEASUREMENT:** Eclipse PB Switch measures CO2 inside the room with its built-in sensor. Air-quality of the room can be checked on main page or air-quality page in detail. Logic functions can be triggered according to the air-quality level via KNX.

**ADAPTIVE BACKLIGHTS:** Light sensor measures the ambient light in the room and provides perfect level of brightness for any environment.

**PROXIMITY SENSOR:** The Eclipse PB Switch is equipped with a sophisticated proximity sensor that detects user is approaching the device and provides a welcoming and comfortable user experience.

## Material and Colour Options

### Brushed Finish

Pure form of nickel, brass, copper and aluminium are brushed with perfect craftsmanship to provide satin effect in each touch to the device.

### Silky-Matte Finish

Aluminium is painted with unique colours and coated with special techniques to provide silky feeling in each touch to the product.



### Ordering Tips:

Use online planner at Core Dealer Portal to create an Eclipse Push Button Switch.

<https://portal.core.com.tr>

## Technical Specification

|                               |   |
|-------------------------------|---|
| <b>Sensors:</b>               | Temperature – Accuracy Rate: +/- 0,2°C<br>Humidity – Accuracy Rate: +/- 2%<br>CO2<br>Proximity & Light                                  |
| <b>Dimensions:</b>            | 86mm X 86mm X 11mm  |
| <b>Casing Material:</b>       | Aluminium, Brass and Stainless Steel depending on the finish selection  |
| <b>Power:</b>                 | 30 VDC - from KNX Bus Line  |
| <b>Consumption:</b>           | < 12 mA from KNX Bus-line   |
| <b>Connectivity:</b>          | KNX-TP  |
| <b>Programming Tool:</b>      | ETS   |
| <b>Installation:</b>          | German IEC/EN 60670 In wall Box   |
| <b>Operating Temperature:</b> | 0°C / +45°C   |
| <b>Storage Temperature:</b>   | -10°C / +55°C   |
| <b>Relative Humidity:</b>     | 95% not condensing  |
| <b>Certification:</b>         | Device complies with Electromagnetic Compatibility Directive(2014/30/EU). Tests carried out according to EN55032:2015 and EN55035:2017. |

Dimensional drawing (all dimensions are in mm)

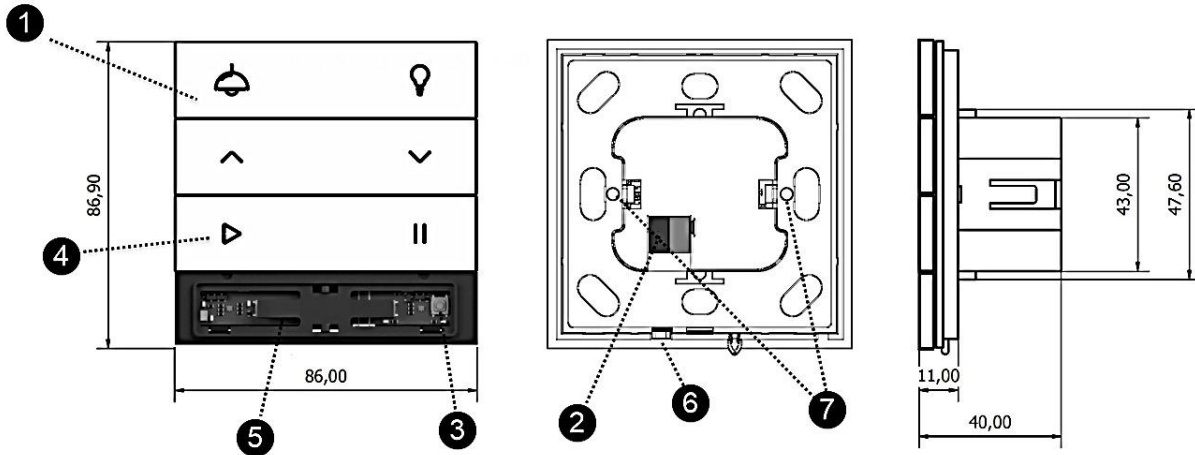

- |                            |  |
|----------------------------|--|
| 1. Folds (Sold Separately) | 5. Position of Temperature and Humidity Sensor |
| 2. KNX Connector           | 6. Position of Light Sensor                    |
| 3. KNX Programming Button  | 7. Screw Holes                                 |
| 4. Customizable icon       |  |